

MARSH & MARSH PROPERTIES

309 Stainland Road, Stainland, HX4 9EH

£340,000



****ATTENTION TO ALL YOUNG AND GROWING FAMILIES**** Do not overlook this substantial and unique property. Here we have a deceptively spacious and very well presented **THREE DOUBLE BEDROOM** mid-terrace property, which has got everything in place, including the staircase, to be able to convert the extremely large loft space into further living accommodation. The property itself is situated in the highly sought after village of Stainland where highly regarded local schools are within walking distance. It has great countryside walks on the doorstep along with stunning countryside views to the rear which can be admired from the low maintenance south facing rear garden. To the front of the property is a low-maintenance garden offering a charming frontage that enhances kerb appeal and features the original Victorian cast iron railings. In brief this fantastic family home comprises of a spacious entrance hallway and two large reception rooms to the ground floor. To the lower ground floor you have a kitchen, another reception room/dining room, a utility room, cloak room and two useful storerooms. Three double bedrooms and the house bathroom are to the first floor where from the landing there is a staircase to the expansive loft space.

Brooke House, 7 Brooke Green, Hipperholme, Halifax, HX3 8ES

Tel: 01422 648 400

info@marshandmarsh.co.uk

www.marshandmarsh.co.uk

ENTRANCE HALL



Accessed via a UPVC double glazed door is this welcoming entrance Hall with tiled flooring, radiator, open staircase, original coving, and access to the lower level.

LIVING ROOM 6.0 x 4.8m (19'8 x 15'8)



A spacious lounge boasting two large UPVC double glazed windows that show the amazing countryside and far reaching views. To the lounge there is an original cast-iron fireplace which houses a living flame coal effect gas fire which is set on a black granite hearth. To complete the room is tasteful décor, coving, and two radiators along with bi-fold doors leading through to the second reception room.

SECOND RECEPTION ROOM 3.8 x 4.8m (12'3 x 15'8)



Another spacious room with exposed wooden floor, a large open fireplace with a multi fuel stove, original, ceiling lights, radiator, and a UPVC bay window.

LOWER LEVEL

KITCHEN 4.7 x 4.8m (15'3 x 15'8)



A wide range of modern wall and base units with solid wooden worktops a double Belfast style sink with a Chrome mixer tap. The large gas and electric cooker comes within the sale of the property and has a large stainless steel cooker hood above. To complete the room there is an

integrated dishwasher, slate effect tile flooring, exposed red brick walling, and two useful storage cupboards. The kitchen has a large open entrance through to the dining room/reception room.



**DINING ROOM/RECEPTION ROOM 6.0 x 4.8m
(19'8 x 15'8)**



The slate effect tiled flooring continues through from the kitchen to the spacious room where you will find a multi fuel stove set within a stone chimney breast, original cupboards to one of the alcoves, two radiators, ceiling spotlights, large UPVC window and UPVC door which both show off the superb views.

UTILITY ROOM

Space and plumbing for both a washing machine and a dryer.

CLOAK ROOM



Consisting of a low flush WC and a hand wash basin. The slate effect tile flooring continues through the utility room and into this space.

STOREROOM

A great storage space with lighting.

STOREROOM TWO

Another useful storage space with lighting.

FIRST FLOOR LANDING



The staircase leads up from the entrance hallway to the spacious landing area with original coving and ceiling spotlights.

BEDROOM ONE 3.0 x 4.9m (9'10 x 16'0)



A good size double bedroom with a feature Stone fireplace, coving, ceiling lights and a large UPVC window that highlights the hillside country views. The wardrobes are attached to the wall and so would come part of the sale of the property.

BEDROOM TWO 3.0 x 3.8m (9'10 x 12'5)



A good size double bedroom with a radiator, coving, ceiling spotlights and a rear UPVC double glazed window that again takes advantage of the views on show. The wardrobes are attached to the wall and so would come part of the sale of the property.

BEDROOM THREE 3.3 x 3.8m (10'9 x 12'5)



A double room with a feature Stone fireplace, a

radiator, ceiling spotlights, coving, and a UPVC double window. The wardrobe is attached to the wall and so would come part of the sale of the property.



BATHROOM 2.7 x 2.6m (8'10 x 8'6)



A traditional designed bathroom featuring a four piece suite that comprises of a corner bathtub with a chrome mixer tap and showerhead, a shower cubicle with a power shower, a high flush toilet, and a pedestal sink. To complete this impressive room is a traditional designed towel radiator, ceiling spotlights, and a UPVC window.

LOFT SPACE 6.0 x 9.6m (19'8 x 31'5)

Building work has been set into Place with a

staircase fitted to build regulations. This is a large space that has potential to develop into a large master bedroom with ensuite facilities. Plumbing and electrics have been set up ready, making it an easier job for anyone wishing to convert this vast space to suit your own needs. It could be two double rooms and a bathroom or just one huge master bedroom with an en-suite bathroom.

EXTERNAL



To the front of the property, you will find a small, enclosed yard. To the rear of the property you will find a low maintenance south facing garden with Yorkshire Stone patio, decking area, and flagged area all of which catch the sun all day/evening and boast the beautiful peaceful countryside views.



Whilst every endeavour is made to ensure the accuracy of the contents of the sales particulars, they are intended for guidance purposes only and do not in any way constitute part of a contract. No person within the company has authority to make or give any representation or warranty in respect of the property. Measurements given are approximate and are intended for illustrative purposes only. Any fixtures, fittings or equipment have not been tested. Purchasers are encouraged to satisfy themselves by inspection of the property to ascertain their accuracy.

309 Stainland Road, Stainland, HX4 9EH

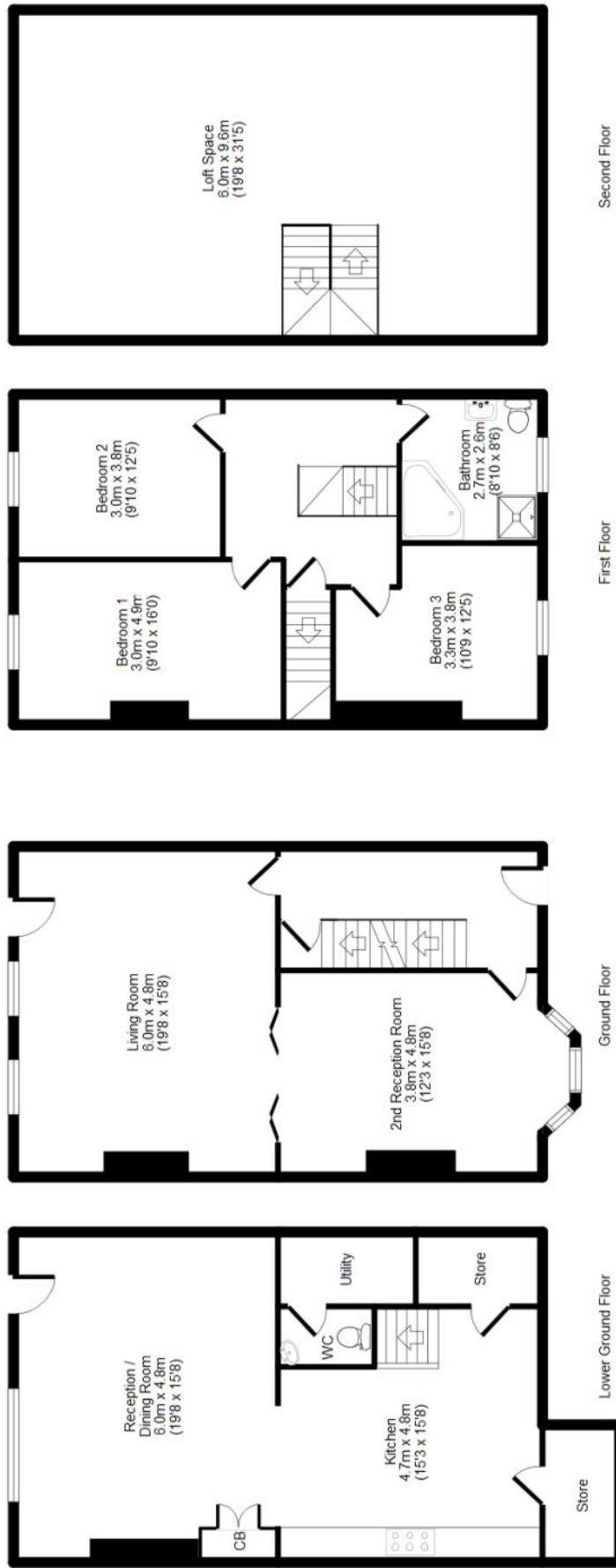

APPROX GROSS INTERNAL FLOOR AREA: 235 sq. m / 2528 sq. ft

Floor Plan measurements are approximate and are for illustrative purposes only. Not to scale. Room dimensions are given as maximum distances. While we do not doubt the floor plans accuracy, we make no guarantee, warranty or representation as to the accuracy and completeness of the floor plan. You or your advisors should conduct a careful, independent investigation of the property to determine to your satisfaction as to the suitability of the property for your space requirements. All images and dimensions are not intended to form part any contract or warranty. (c) Marsh & Marsh Properties

Brooke House, 7 Brooke Green, Hipperholme, Halifax, HX3 8ES

Tel: 01422 648 400

info@marshandmarsh.co.uk

www.marshandmarsh.co.uk